

# Anorectal stoma care products



Product name:	C001 one-piece ostomy bag (closed)
Cutting range:	20mm~65mm
Size:	15cm×19.5cm
Qty:	10 pieces/box, 200 pieces/carton
Measurement:	33cm×33cm×20cm
Gross weight:	4.5kg
Material:	High barrier film, non-woven fabric, medical thermosensitive adhesive
User:	Suitable for stomas to collect stoma excreta.

**Clear scale**

The cutting hole has many sizes and clear scale, which is convenient for cutting

**Medical non-woven lining**

Soft, comfortable and breathable, high moisture absorption, reducing friction

**Medical colloid chassis**

The non-toxic hydrocolloid, low tear pain, low sensitivity, not easy to move glue

**Translucent skin design**

Good concealment and easy observation



The advantage of closed ostomy bag lies in one-time emptying, convenience and no washing. It is suitable for patients who have formed stool and change it 1~2 times a day.

The translucent skin color bag can prevent patients from directly seeing feces and reduce the visual stimulation to patients.

The non-woven fabric lining material is light and soft, has good skin affinity, reduces the friction sound, absorbs sweat and prevents the bag from clinging to the skin; The heat sensitive adhesive has moderate viscosity and will not hurt the skin when removing the application.

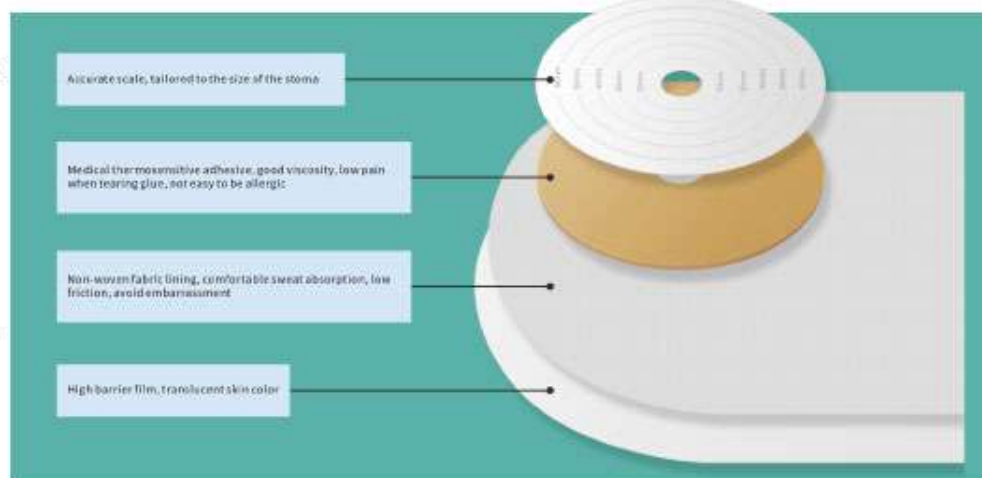

Accurate scale, tailored to the size of the stoma

Medical thermosensitive adhesive, good viscosity, low pain when tearing glue, not easy to be allergic

Non-woven fabric lining, comfortable sweat absorption, low friction, avoid embarrassment

High barrier film, translucent skin color



1. Clean the stoma and surrounding skin and wipe dry

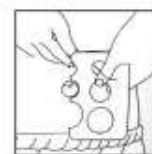

2. Measures with the attached stoma size card



3. Cut a suitable opening hole according to the measurement result

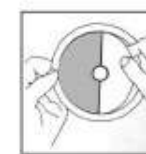

4. Remove the protective release paper



4. Stick it from bottom to top and hold it for a few minutes. Strengthen fixation.



Product name:	A001 one-piece ostomy bag (opening)
Cutting range:	20mm~65mm
Size:	15cm × 27,5cm
Qty:	10 pieces/box, 200 pieces/carton
Measurement:	33cm × 33cm × 20cm
Gross weight:	4.8kg
Material:	High barrier film, non-woven fabric, medical thermosensitive adhesive
Use:	Suitable for stomas to collect stoma excreta



The opening ostomy bag is that it is easy to empty, the replacement times are relatively reduced, and it can be cleaned. It is suitable for the situation with more and thinner feces.

Skin color translucent bag can prevent patients from directly seeing feces and reduce the visual stimulation to patients.

The non-woven fabric lining material is light and soft, has good skin affinity, reduces the friction sound, absorbs sweat and prevents the bag from clinging to the skin; The heat sensitive adhesive has moderate viscosity and will not hurt the skin when removing the application.

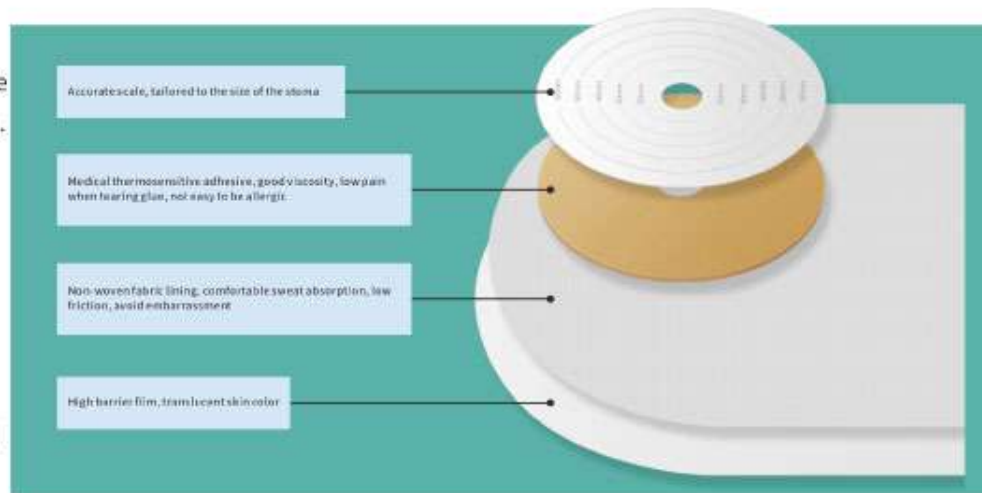

1. Clean the stoma and surrounding skin and wipe dry

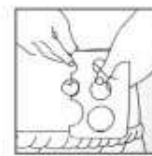

2. Measure with the attached stoma size card

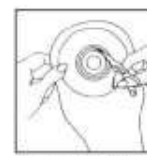

3. Cut a suitable opening hole according to the measurement result.



4. Stick it from bottom to top and hold it for a few minutes, Strengthen fixation.



5. Open the seal and pour it out at the urinal.



Product name:	A002 one-piece ostomy bag (opening)
Cutting range:	20mm-65mm
Size:	15cm × 27.5cm
Qty:	10 pieces/box, 200 pieces/carton
Measurement:	33cm × 33cm × 20cm
Gross weight:	4.7kg
Material:	High barrier film, non-woven fabric, medical thermosensitive adhesive, Activated carbon filter
Use:	Suitable for stomas to collect stoma excreta

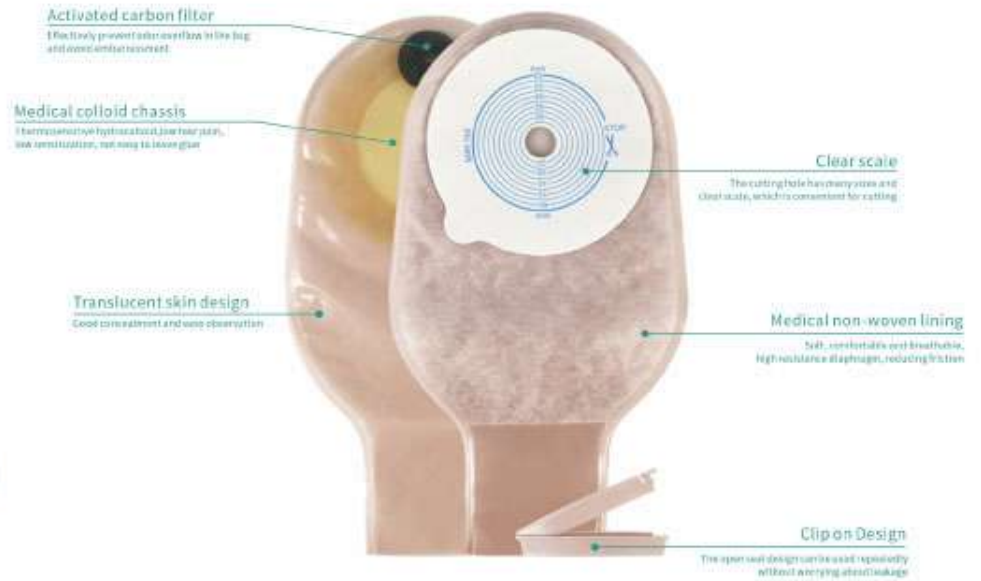

The opening ostomy bag is that it is easy to empty, the replacement times are relatively reduced, and it can be cleaned. It is suitable for the situation with more and thinner feces.

Skin color translucent bag can prevent patients from directly seeing feces and reduce the visual stimulation to patients.

The non-woven fabric lining material is light and soft, has good skin affinity, reduces the friction sound, absorbs sweat and prevents the bag from clinging to the skin; The heat sensitive adhesive has moderate viscosity and will not hurt the skin when removing the application.

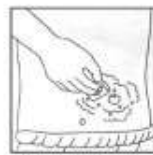
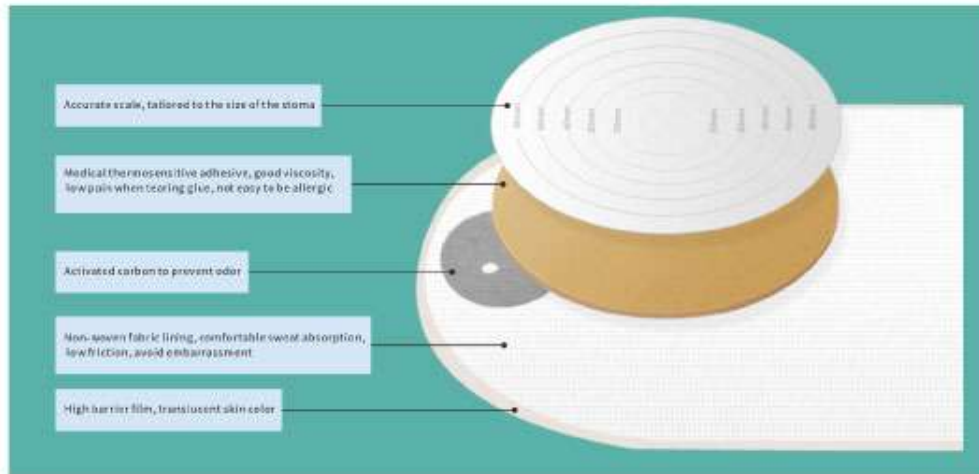

1. Clean the stoma and surrounding skin and wipe dry

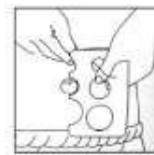

2. Measure with the attached stoma size card

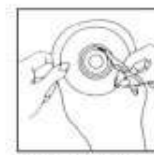

3. Cut a suitable opening hole according to the measurement result



4. Stick it from bottom to top and hold it for a few minutes. Strengthen fixation



5. Open the seal and pour it out at the toilet



Product name:	A003 one-piece ostomy bag (opening)
Cutting range:	20mm~65mm
Size:	15cm×27.5cm
Qty:	10 pieces/box,200 pieces/carton
Measurement:	33cm×33cm×20cm
Gross weight:	5.1kg
Material:	High barrier film, non-woven fabric, medical thermosensitive adhesive
Use:	Suitable for stomas to collect stoma excreta

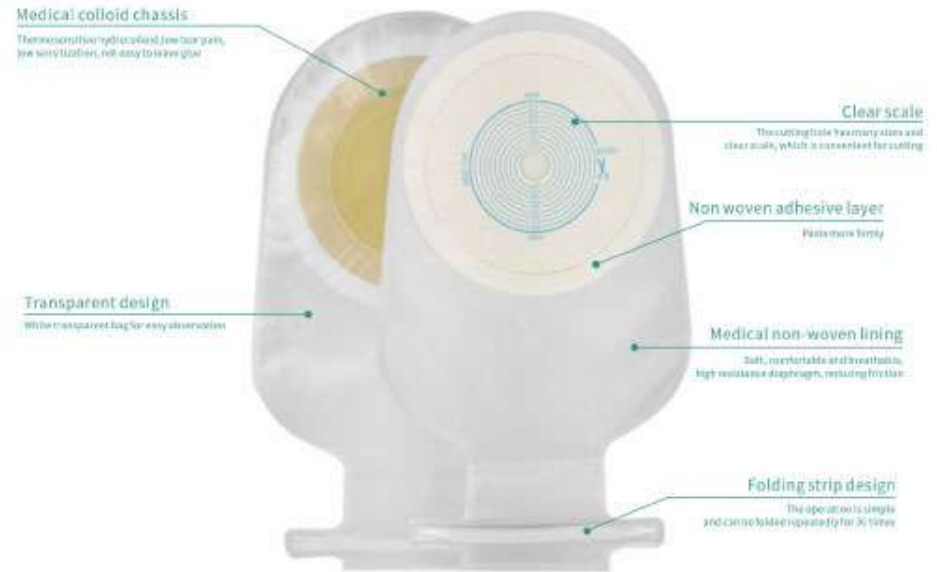

The opening ostomy bag is that it is easy to empty, the replacement times are relatively reduced, and it can be cleaned. It is suitable for the situation with more and thinner feces.

White bag is convenient for observation, mesh film lining is comfortable and breathable, less friction and avoid embarrassment; the adhesive has moderate viscosity and will not hurt the skin when removing.

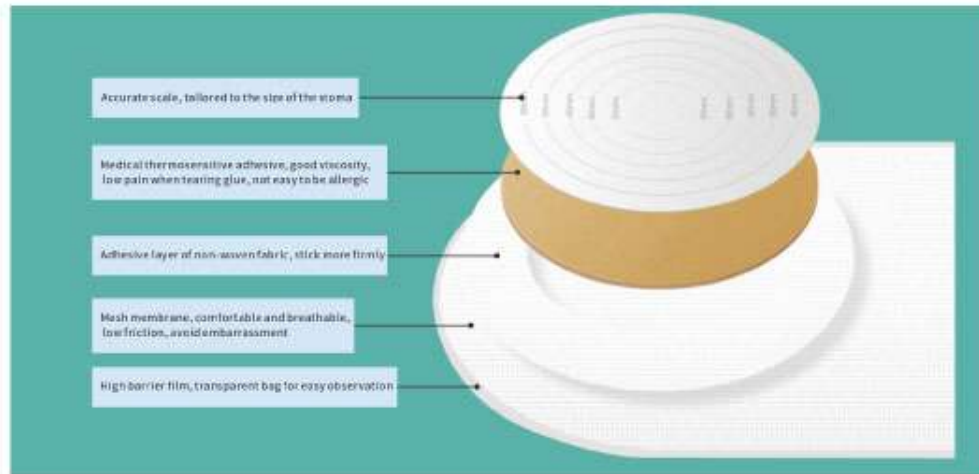

1. Clean the stoma and surrounding skin and wipe dry.

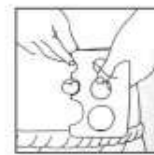

2. Measure with the attached stoma size card.

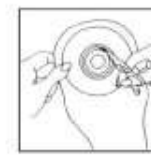

3. Cut a suitable opening hole according to the measurement result.



4. Stick it from bottom to top and hold it for a few minutes. Strengthen fixation.



5. Open the seal and pour it out at the arrival.



Product name:	A003-8 one-piece ostomy bag (opening)
Cutting range:	20mm~65mm
Size:	15cm × 27.5cm
Qty:	10 pieces/box, ---pieces/carton
Measurement:	---cm × ---cm × ---cm
Gross weight:	---kg
Material:	High barrier film, non-woven fabric, medical thermosensitive adhesive
Use:	Suitable for stomas to collect stoma excreta

**Exhaust on-off valve**  
The switch is convenient, and the exhaust can be opened at any time.

**Medical colloid chassis**  
Thermosensitive hydrocolloid, low tear pain, low sensitization, not easy to leave glue.

**Transparent skin design**  
White transparent bag for easy observation.

**Folding strip design**  
Easy to disassemble and clean and discharge at any time.

**Clear scale**  
The cutting tool has many sizes and clear scale, which is convenient for cutting.

**Medical non-woven lining**  
Soft, comfortable and breathable, high moisture absorption, reducing friction.



The opening ostomy bag is that it is easy to empty, the replacement times are relatively reduced, and it can be cleaned. It is suitable for the situation with more and thinner feces.

White bag is convenient for observation, mesh film lining is comfortable and breathable, less friction and avoid embarrassment; the adhesive has moderate viscosity and will not hurt the skin when removing.

Accurate scale, tailored to the size of the stoma

Medical thermosensitive adhesive, good viscosity, low pain when tearing glue, not easy to be allergic

Adhesive layer of non-woven fabric, stick more firmly

Mesh membrane, comfortable and breathable, low friction, avoid embarrassment

High barrier film, transparent bag for easy observation

Exhaust on-off valve, easy to operate and exhaust at any time

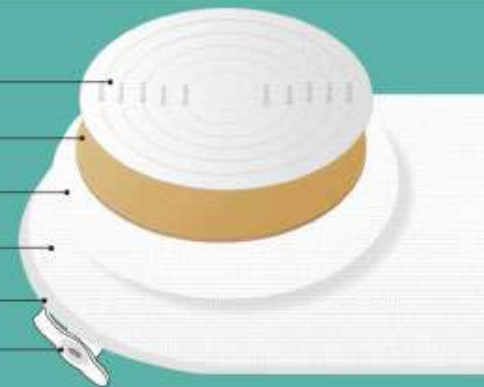

1. Clean the stoma and surrounding skin and wipe dry.



2. Measure with the attached stoma size card.

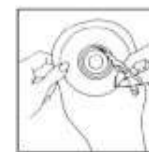

3. Cut a suitable opening hole according to the measurement result.



4. Stick it there bottom to top and hold it for a few minutes, strengthen fixation.



5. Open the seal and pour it out at the urinal.



Product name:	B021-1 Two-piece ostomy bag(opening)
Supporting chassis:	B021
Size:	15cm×27.5cm
Qty:	10 pieces/box,200 pieces/carton
Measurement:	33cm×33cm×20cm
Gross weight:	3.7kg
Material:	High barrier film, non-woven fabric, Activated carbon filter
Use:	Suitable for stomas to collect stoma excreta

**Activated carbon filter**  
Effectively prevent odor overflow to the bag, and avoid embarrassment

**Buckle design**  
It can be equipped with a belt to clamp the chassis, which is not easy to fall off

**Medical non-woven lining**  
Soft, comfortable and breathable, high resistant diaphragm, reducing friction

**Translucent skin design**  
Good concealment and easy observation

**Clip on Design**  
The opened design can be used repeatedly, without worrying about leakage



The bag body and chassis of the two-piece ostomy bag can be separated, the chassis can be pasted on the abdominal wall and then put on the ostomy bag.

The direction of the ostomy bag opening can be changed at will, and the ostomy bag can be removed for cleaning and replacement at any time. It can be reused after cleaning and drying.

The chassis is generally replaced once every 3-5 days, no more than 7 days. Due to the long wearing time, the skin protection effect is better than the frequent removal of one-piece ostomy bag.

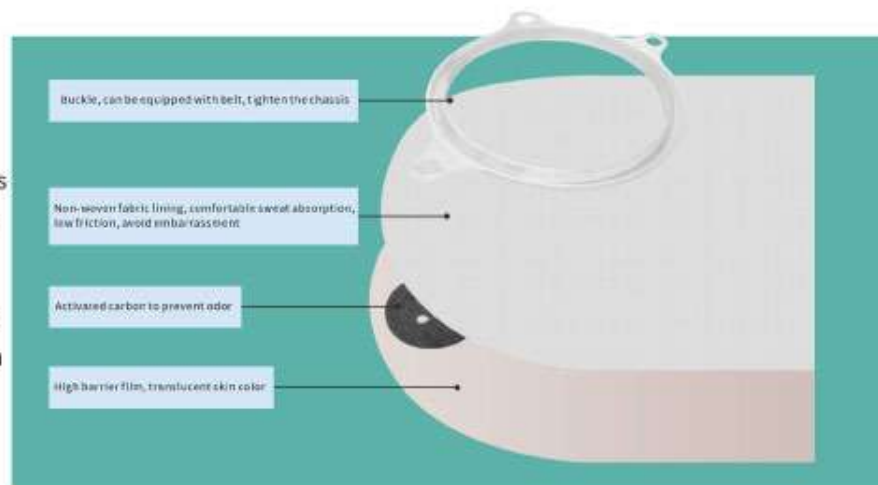

1. Clean the stoma and surrounding skin and wipe dry



2. Measure with the attached stoma size card

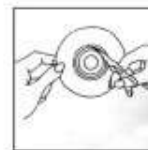

3. Cut a suitable opening hole according to the measurement result



4. And carefully stick it from the middle to the outside.



5. Press the adhesive for a few minutes to strengthen the fixation



Product name:	B0345-2 Two-piece ostomy bag(opening)
Supporting chassis:	B0345
Size:	15cm×27.5cm
Qty:	10 pieces/box,200 pieces/carton
Measurement:	42cm×34cm×31cm
Gross weight:	3.6kg
Material:	High barrier film, non-woven fabric, Activated carbon filter
Use:	Suitable for stomas to collect stoma excreta

**Activated carbon filter**  
Effectively prevent odor overflow in the bag and avoid embarrassment



**Latch design**  
Clamp the chassis tightly to prevent it from falling off

**Translucent skin design**  
Good concealment and easy absorption

**Medical non-woven lining**  
Soft, comfortable and breathable, high resistance to phlegm, reducing friction

**Clip on Design**  
The open seal design can be used repeatedly without worrying about leakage

The bag body and chassis of the two-piece ostomy bag can be separated, the chassis can be pasted on the abdominal wall and then put on the ostomy bag.

The direction of the ostomy bag opening can be changed at will, and the ostomy bag can be removed for cleaning and replacement at any time. It can be reused after cleaning and drying.

The chassis is generally replaced once every 3-5 days, no more than 7 days. Due to the long wearing time, the skin protection effect is better than the frequent removal of one-piece ostomy bag.

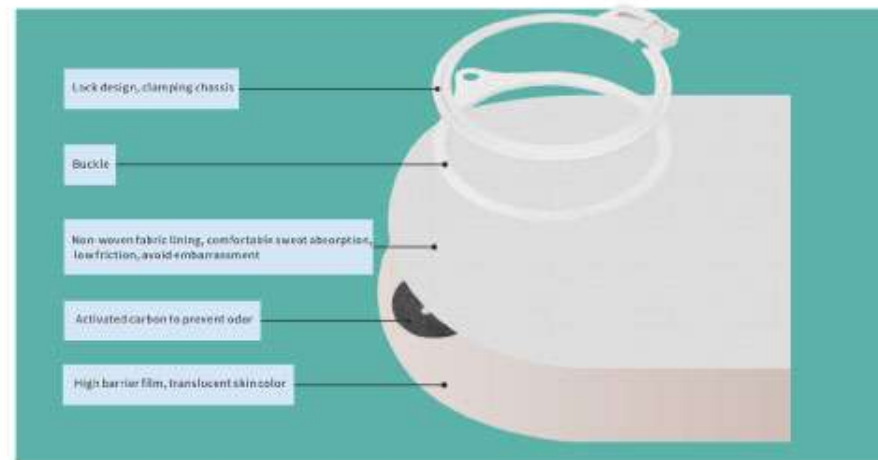

1. Clean the stoma and surrounding skin and wipe dry



2. Measure with the attached stoma size card

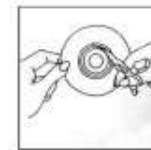

3. Cut a suitable opening hole according to the measurement result



4. And carefully stick it from the middle to the outside.



5. Press the adhesive for a few minutes to strengthen the fixation



Product name:	B041 Two-piece ostomy bag (opening)
Supporting chassis:	B0460
Size:	15cm×27.5cm
Qty:	10 pieces/box, 200 pieces/carton
Measurement:	42cm×34cm×31cm
Gross weight:	3.7kg
Material:	High barrier film, non-woven fabric, Activated carbon filter
Use:	Suitable for stomas to collect stoma excreta

**Activated carbon filter**  
Effectively prevent odor overflow in the bag and avoid embarrassment

**Buckle design**  
It can be equipped with a belt to clamp the chassis

**Translucent skin design**  
Good concealment and easy observation

**Medical non-woven lining**  
Soft, comfortable and breathable, high resistance to leakage, reducing friction

**Clip on Design**  
The open end design can be used repeatedly without worrying about leakage

The bag body and chassis of the two-piece ostomy bag can be separated, the chassis can be pasted on the abdominal wall and then put on the ostomy bag.

The direction of the ostomy bag opening can be changed at will, and the ostomy bag can be removed for cleaning and replacement at any time. It can be reused after cleaning and drying.

The chassis is generally replaced once every 3-5 days, no more than 7 days. Due to the long wearing time, the skin protection effect is better than the frequent removal of one-piece ostomy bag.

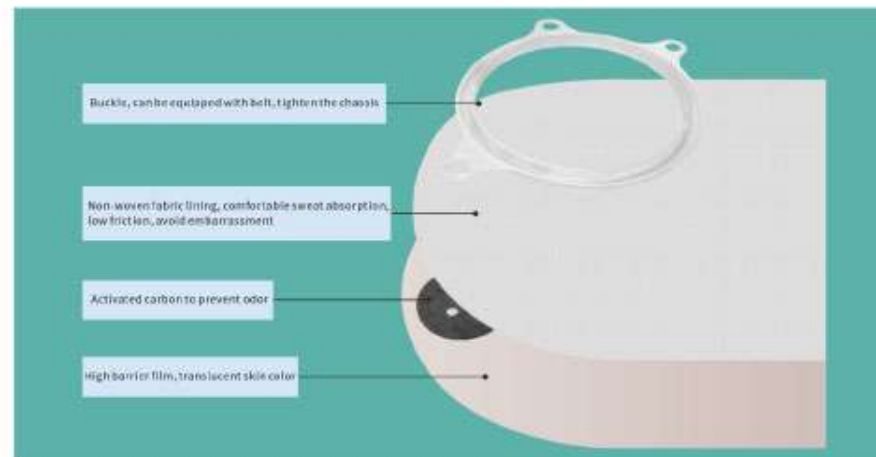

1. Clean the stoma and surrounding skin and wipe dry



2. Measure with the attached stoma size card

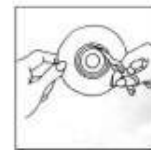

3. Cut a suitable opening hole according to the measurement result



4. And carefully stick it from the middle to the outside.



5. Press the adhesive for a few minutes to strengthen the fixation