

Urostomy care products



Product name:	E001 One-piece urinary ostomy bag
Cutting range:	20mm~45mm
Size:	14.5cm×27.5cm
Qty:	10 pieces/box, 200 pieces/carton
Measurement:	42cm×34cm×31cm
Gross weight:	6.6kg
Material:	High barrier film, non-woven fabric, medical thermosensitive adhesive
Use:	Suitable for stomas to collect stoma excreta

Medical colloid chassis

Thermosensitive hydrocolloid barrier pain, low sensitization, not easy to tear glue

Transparent skin design

White transparent bag for easy observation

Anti countercurrent design

Anti reflux structure to prevent urine reflux

Clear scale

The cutting hole has many sizes and clear scale, which is convenient for cutting

Medical non-woven lining

Soft, comfortable and breathable, high resistance to rupture, reducing friction

On-off valve design

Simple operation, good tightness, no need to worry about leakage

The opening ostomy bag is that it is easy to empty, the replacement times are relatively few, it can be cleaned, and the transparent bag body is easy to observe

The non-woven lining material is light and soft, has good skin affinity, reduces the friction sound, absorbs sweat, prevents the bag body from clinging to the skin, has moderate heat sensitive adhesive, and does not hurt the skin when removing and applying.

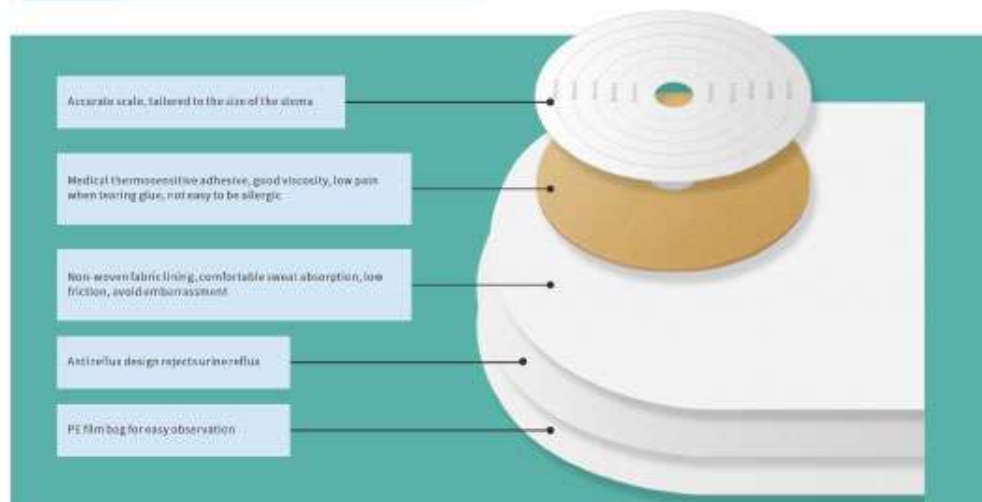

Accurate scale, tailored to the size of the stoma

Medical thermosensitive adhesive, good viscosity, low pain when tearing glue, not easy to be allergic

Non-woven fabric lining, comfortable sweat absorption, low friction, avoid embarrassment

Anti-reflux design rejects urine reflux

PE film bag for easy observation



1. Clean the stoma and surrounding skin and wipe dry

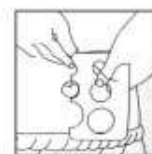

2. Measure with the attached stoma size card

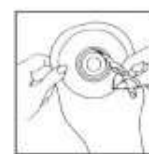

3. Cut a suitable opening hole according to the measurement result



4. Stick it from bottom to top and hold it for a few minutes. Strengthen the adhesion.



5. Pinch the upper end of the drain valve and open the plug to discharge



Product name:	E002-T One-piece urinary ostomy bag
Cutting range:	20mm~48mm
Size:	15cm×27.5cm
Qty:	10 pieces/box, 200 pieces/carton
Measurement:	42cm×34cm×31cm
Gross weight:	6.1kg
Material:	High barrier film, non-woven fabric, medical thermosensitive adhesive, Non woven adhesive
Use:	Suitable for stomas to collect stoma excreta



The opening ostomy bag is that it is easy to empty, the replacement times are relatively few, it can be cleaned, and the transparent bag body is easy to observe

The non-woven lining material is light and soft, has good skin affinity, reduces the friction sound, absorbs sweat, prevents the bag body from clinging to the skin, has moderate heat sensitive adhesive, and does not hurt the skin when removing and applying.

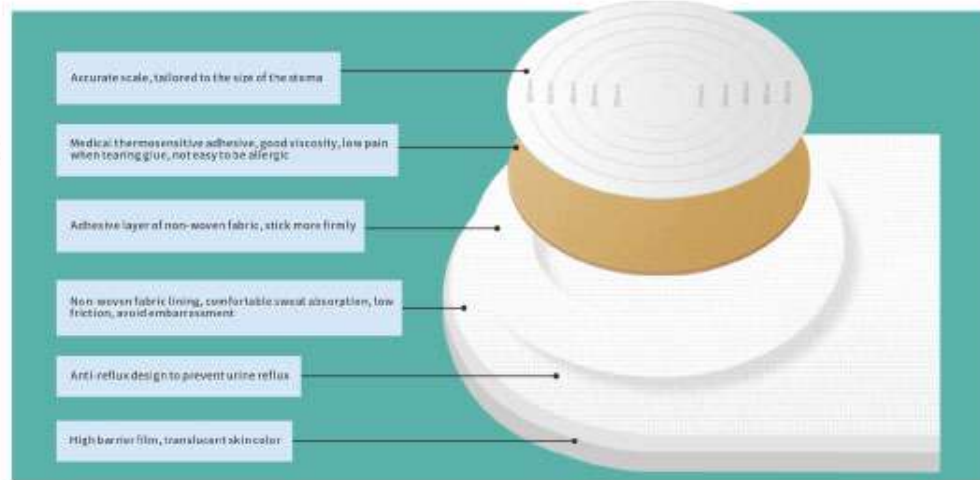

1. Clean the stoma and surrounding skin and wipe dry

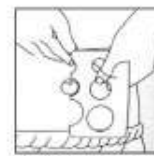

2. Measure with the attached stoma size card

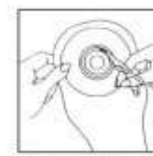

3. Cut a suitable opening hole according to the measurement result



4. Stick it from bottom to top and hold it for a few minutes, strengthen fixation



5. Pinch the upper end of the drain valve and open the plug to discharge



Product name:	FB0345-1 Two-piece urinary ostomy bag
Supporting chassis:	B0345
Size:	15cm×27.5cm
Qty:	10 pieces/box,200 pieces/carton
Measurement:	42cm×34cm×31cm
Gross weight:	4.3kg
Material:	High barrier film, non-woven fabric
Use:	Suitable for stomas to collect stoma excreta

The bag body and chassis of the two-piece ostomy bag can be separated, the chassis can be pasted on the abdominal wall and then put on the ostomy bag.

The direction of the ostomy bag opening can be changed at will, and the ostomy bag can be removed for cleaning and replacement at any time. It can be reused after cleaning and drying.

The chassis is generally replaced once every 3-5 days, no more than 7 days. Due to the long wearing time, the skin protection effect is better than the frequent removal of one-piece ostomy bag.



1. Clean the stoma and surrounding skin and wipe dry



2. Measure with the attached stoma size card



3. Cut a suitable opening hole according to the measurement result



4. Stick it from bottom to top and hold it for a few minutes, strengthen fixation.



5. Pinch the upper end of the drain valve and open the plug to discharge